

# / BROKK 130<sup>+</sup>



- Increased uptime and power over time
- Smart sensors and operator support system
- Lightweight control box with tilted joysticks
- 20,2 kW Brokk SmartPower+ electrical system
- Compatible with 16 A and 32 A fuses for flexible power options



The **Brokk 130<sup>+</sup>** sets a new benchmark in demolition, delivering more power, endurance, and efficiency than ever before. Designed for demanding environments, it combines high impact energy with intelligent power management, making it ideal for confined and hard-to-reach areas. With a 360-degree working radius, it ensures maximum flexibility in any operation.

Equipped with the BHB 175 breaker and the advanced Brokk SmartPower+ system, the **Brokk 130<sup>+</sup>** maximizes efficiency for superior demolition performance. It delivers 20% more hitting force and 40% higher impact frequency, boosting production by 40–60%. Every movement is precisely controlled for smoother operation, greater force, and optimized productivity.

Hydraulic breaker in images: BHB 175  
Load and stability diagram available on request

## TECHNICAL DATA

<b>Slewing speed</b>	10 sec/360°
<b>Transport speed, max.</b>	2.5 km/h; 1.6 mph
<b>Climbing inclination, max.</b>	30°
<b>Hydraulic system capacity</b>	40 l; 10.6 US gal
<b>Pump type</b>	Variable load-sensing
<b>System pressure</b>	18 MPa; 2611 psi
<b>Pump flow 50 Hz</b>	56 l/min; 14.8 US gal/min
<b>60 Hz</b>	66 l/min; 17.4 US gal/min
<b>Power technology</b>	Brokk SmartPower+
<b>Electric motor type</b>	ABB
<b>Power*</b>	20,2 kW
<b>Recommended fuse size*</b>	32 A
<b>Minimum fuse size (reduced power)*</b>	16 A
<b>Starting device</b>	Soft start
<b>Control type</b>	Portable
<b>Signal code</b>	Digital
<b>Transfer</b>	Professional radio/Cable
<b>Range, radio</b>	Up to 300 m
<b>Machine weight**</b>	990 kg; 2183 lbs
<b>Recommended attachment weight</b>	180 kg; 397 lbs
<b>Sound power level L<sub>WA</sub>***</b>	91 dB(A)

\*Valid for 400 V/50 Hz and 440 V/60 Hz

\*\*Excluding options and attachment

\*\*\*Measured according to directive 2000/14/EC, excl. attachment

## OPTIONS

Extra cylinder protection

Rubber caterpillar tracks

Steel caterpillar tracks

Heat-resistant hoses

Forced draft cooling for machine

Forced draft cooling for breaker

Steel pads

Air flushing for breaker

Water spray for breaker

Extra hydraulic function

Drainage hose

CAN cable connection

Counterweight

Lifting eyes (regular lifting points are standard)

Extra support roller for rubber caterpillar tracks

Motion warning

Load holding valves

## SIZE

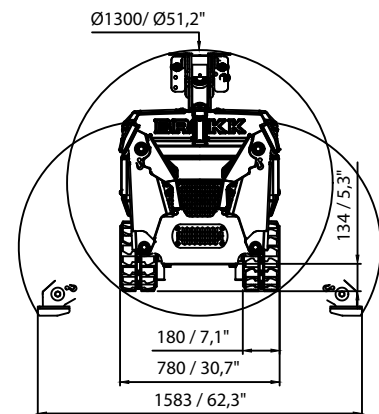
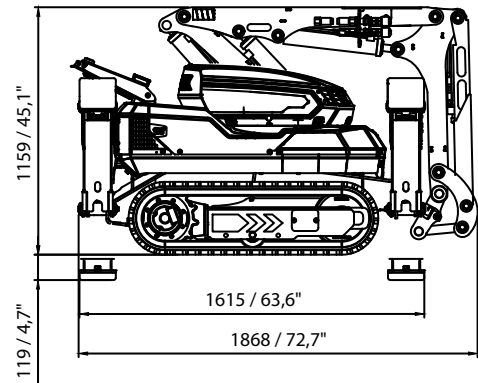

## RANGE

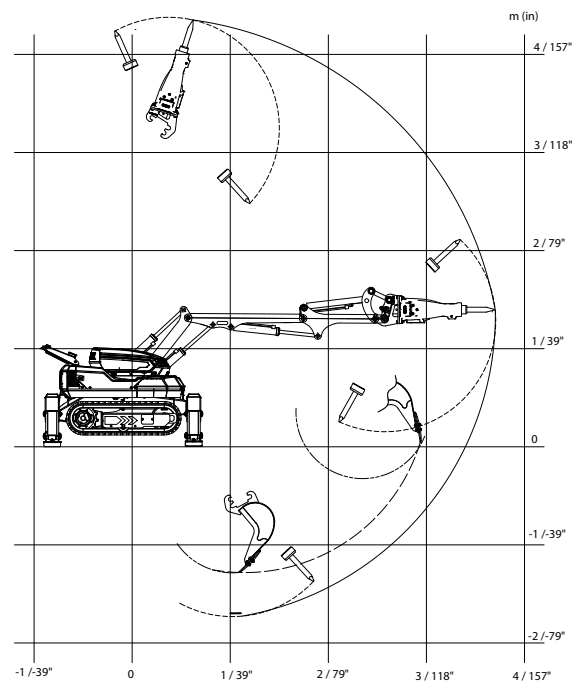

Tolerances for technical data may vary

DISTRIBUTED BY:



**AIRINDO SAKTI**

[www.airindosakti.co.id](http://www.airindosakti.co.id)