

# / BROKK 70<sup>+</sup>



Enhanced with a seamlessly integrated hydraulic system, the newest generation Brokk 70<sup>+</sup> boasts unparalleled power within its compact frame. The Brokk 70<sup>+</sup> emerges as the ultimate solution for secure and efficient demolition within tight quarters, revolutionizing the landscape of confined space demolition. With new state-of-the-art features, the Brokk 70<sup>+</sup> redefines possibilities within the construction industry and beyond thanks to an increase in uptime and consistent power delivery over time. Expertly engineered to combine superior power, compact dimensions, and feather-light weight, the Brokk 70<sup>+</sup> opens up opportunities for demolition in areas once deemed inaccessible.

- Increase in uptime and more power over time
- Smart sensors and two-way communication system
- Tilted joysticks and ergonomic control box weighing less than 3kg
- 9.8 kW Brokk SmartPower+ electrical system
- Powered with only 16 A electricity fuse
- Weighs less than 560 kg



Hydraulic breaker in images: BHB 105.  
Load and stability diagram available on request

## TECHNICAL DATA

<b>Slewing speed</b>	6,5 sec/245°
<b>Transport speed, max.</b>	2.7 km/h; 1.7 mph
<b>Climbing inclination, max.</b>	30°
<b>Hydraulic system capacity</b>	27 l; 7.1 US gal
<b>Pump type</b>	Variable load-sensing
<b>System pressure</b>	17 MPa; 2466 psi
<b>Pump flow 50 Hz</b>	27 l/min; 7 US gal/min
<b>60 Hz</b>	32 l/min; 8 US gal/min
<b>Power technology</b>	SmartPower+
<b>Electric motor type</b>	ABB
<b>Power*</b>	9.8 kW
<b>Recommended fuse size*</b>	16 A
<b>Starting device</b>	Direct start
<b>Control unit</b>	Portable
<b>Signal code</b>	Digital
<b>Transfer</b>	Professional radio/Cable
<b>Range, radio</b>	Up to 300 m
<b>Machine weight**</b>	560 kg; 1235 lbs
<b>Recommended attachment weight</b>	105 kg; 231 lbs
<b>Sound power level L<sub>WA</sub>***</b>	90 dB(A)

\*Valid for 400 V/50 Hz and 440 V/60 Hz

\*\*Excluding attachment and extra equipment

\*\*\*Measured according to directive 2000/14/EC

## SIZE

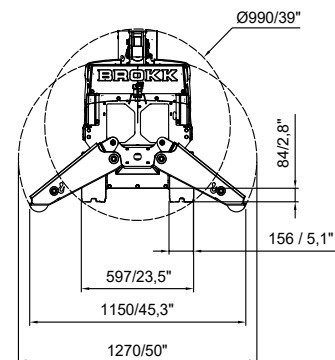
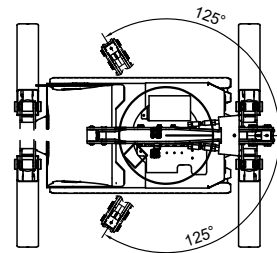
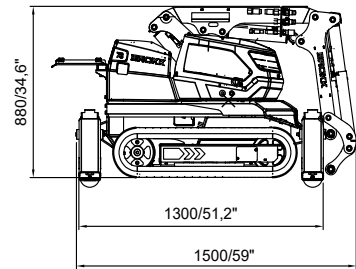

## OPTIONS

Extra cylinder protection

Forced draft cooling for machine

Forced draft cooling for breaker

Steel pads

Water spray for breaker

Extra hydraulic function

Lifting eyes (regular lifting points are standard)

Motion warning

## RANGE

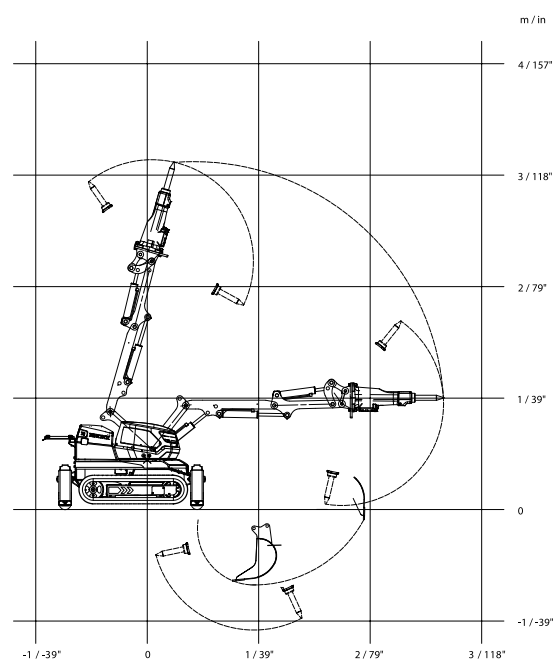

DISTRIBUTED BY:

 **AIRINDO SAKTI**  
www.airindosakti.co.id

Tolerances for technical data may vary